

Manual Valve, PTFE/CTFE Distribution Flow Path, 2- ports(180°), HVX (1-5)

Specification Sheet (Part/REF # 86910)

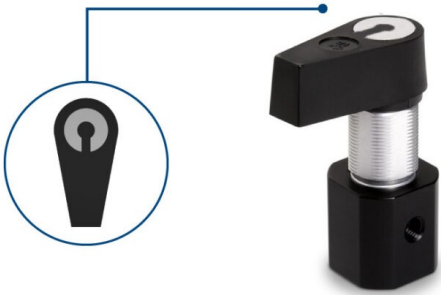

Valves designed for hand actuation. These valves have high reliability and an inert flow path.

Product Specifications

| | |
|----------------------------|--------------------------------------|
| Valve Model | 1-5 |
| Valve Model Description | Distribution Flow Path 2-ports(180°) |
| Fluid Path | PTFE/CTFE |
| Valve Size | HVX |
| Nominal Port Diameter | 0.118 inch (3 mm) |
| Valve Outer Body Dimension | 1 inch (25.4 mm) |
| Housing Material | Aluminum |
| Total Dead Volume | 108.8 µL |
| Actuated | Manual |
| Break Away Torque | 65 in oz. (455 mNm) |
| Panel Mounting | Yes |
| Panel Thickness | 0.625 inch (15.9 mm) |
| Thread Depth | 0.219 inch (5.6 mm) |
| Threaded Connection | ¼-28 |
| Operating Temp High | 38 °C (100 °F) |
| Operating Temp Low | -12 °C (10 °F) |
| Operating Pressure | 0 to 100 psig (0 to 6.9 bar) |
| Storage Temp High | 38 °C (100 °F) |
| Storage Temp Low | -18 °C (0 °F) |

Specifications are subject to change without notice
<https://www.hamiltoncompany.com/valves/86910>

Spec. Version B