

# MVP 4-2, 90° Flow Path, 4 Port Valve, HVXM

Specification Sheet (Part/REF # 36780)

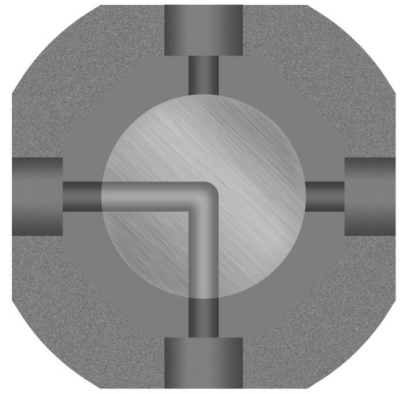

Hamilton Modular Valve Positioners are exceptionally easy to service and modify. It is very simple to remove and replace their snap-in valves with other configurations to achieve different fluid delivery with the same positioner unit, maximizing flexibility and value.

## Product Specifications

Valve Model	4-2
Valve Model Description	90° Flow Path 4-ports
Fluid Path	PTFE/CTFE
Valve Size	HVXM
Nominal Port Diameter	0.118 inch (3 mm)
Valve Outer Body Dimension	0.75 inch (19.1 mm)
Housing Material	Aluminum
Total Dead Volume	19 µL
Actuated	Modular Valve Positioner
Break Away Torque	65 in oz. (455 mNm)
Panel Mounting	No
Thread Depth	0.219 inch (5.6 mm)
Threaded Connection	¼-28
Operating Temp High	38 °C (100 °F)
Operating Temp Low	-12 °C (10 °F)
Operating Pressure	0 to 100 psig (0 to 6.9 bar)
Storage Temp High	38 °C (100 °F)
Storage Temp Low	-18 °C (0 °F)

Specifications are subject to change without notice  
<https://www.hamiltoncompany.com/valves/36780>

Spec. Version B